



Shropshire Council

TOWN AND COUNTRY PLANNING ACT 1990

**THE TOWN AND COUNTRY PLANNING (TREE PRESERVATION) (ENGLAND)
REGULATIONS 2012**

TREE PRESERVATION ORDER

relating to

Shropshire Council (Loppington Village West) TPO 2014

Order Number:SC/00208/14

**Town and Country Planning Act 1990
Shropshire Council (Loppington Village West) TPO 2014**

The Shropshire Council, in exercise of the powers conferred on them by section 198 of the Town and Country Planning Act 1990 make the following Order—

Citation

1. This Order may be cited as the Shropshire Council (Loppington Village West) TPO 2014.

Interpretation

2. (1) In this Order “the authority” means the Shropshire Council

(2) In this Order any reference to a numbered section is a reference to the section so numbered in the Town and Country Planning Act 1990 and any reference to a numbered regulation is a reference to the regulation so numbered in the Town and Country Planning (Tree Preservation) (England) Regulations 2012.

Effect

3. (1) Subject to article 4, this Order takes effect provisionally on the date on which it is made

(2) Without prejudice to subsection (7) of section 198 (power to make tree preservation orders) or subsection (1) of section 200 (tree preservation orders: Forestry Commissioners), and subject to the exceptions in regulation 14, no person shall

(a) cut down, top, lop, uproot, wilfully damage or wilfully destroy; or

(b) cause or permit the cutting down, topping, lopping, uprooting, wilful damage or willful destruction of,

any tree specified in the Schedule to this Order except with the written consent of the authority in accordance with regulations 16 and 17, or of the Secretary of State in accordance with regulation 23, and, where such consent is given subject to conditions, in accordance with those conditions.

Application to trees to be planted pursuant to a condition

4. In relation to any tree identified in the first column of the Schedule by the letter “C”, being a tree to be planted pursuant to a condition imposed under paragraph (a) of section 197 (planning permission to include appropriate provision for preservation and planting of trees), this Order takes effect as from the time when the tree is planted.

**THE COMMON SEAL of
The SHROPSHIRE COUNCIL**

Dated this 15th December 2014

Was hereunto affixed as a deed in the presence of:

299905

T W Colford

.....
Authorised by the Council to sign in that behalf

Dated this [insert date of Order] day of [insert month and year]

Signed on behalf of the Shropshire Council

.....
Authorised by the Council to sign in that behalf

CONFIRMATION OF ORDER

This Order was confirmed by the Shropshire Council without modification on the
THIRD day of JUNE 2015

Or

This Order was confirmed by the Shropshire Council subject to the modification indicated by The removal
on the day of 20 of T3 & T4 from
Schedule 2 and the
plan.

Signed on behalf of Shropshire Council:



Authorised by the Council to sign in that behalf COUNTY ARBORICULTURALIST

DECISION NOT TO CONFIRM ORDER

A decision not to confirm this Order was taken by the Shropshire Council on the
day of 20

Signed on behalf of Shropshire Council:

Authorised by the Council to sign in that behalf

VARIATION OF ORDER

This Order was varied by the Shropshire Council on the day of 20 by a
variation order under reference number a copy of which is attached

Signed on behalf of Shropshire Council:

Authorised by the Council to sign in that behalf

REVOCATION OF ORDER

This Order was revoked by the Shropshire Council on the day of 20

Signed on behalf of Shropshire Council:

Authorised by the Council to sign in that behalf

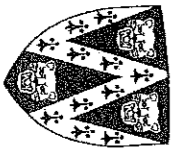

Shropshire Council

© Crown copyright and database rights 2014
Ordnance Survey 100049049

Shropshire Council (Loppington Village West) TPO 2014

Environment
The Shirehall, Abbey Foregate,
Shrewsbury, Shropshire, SY2 6ND
Scale : 1:1,500

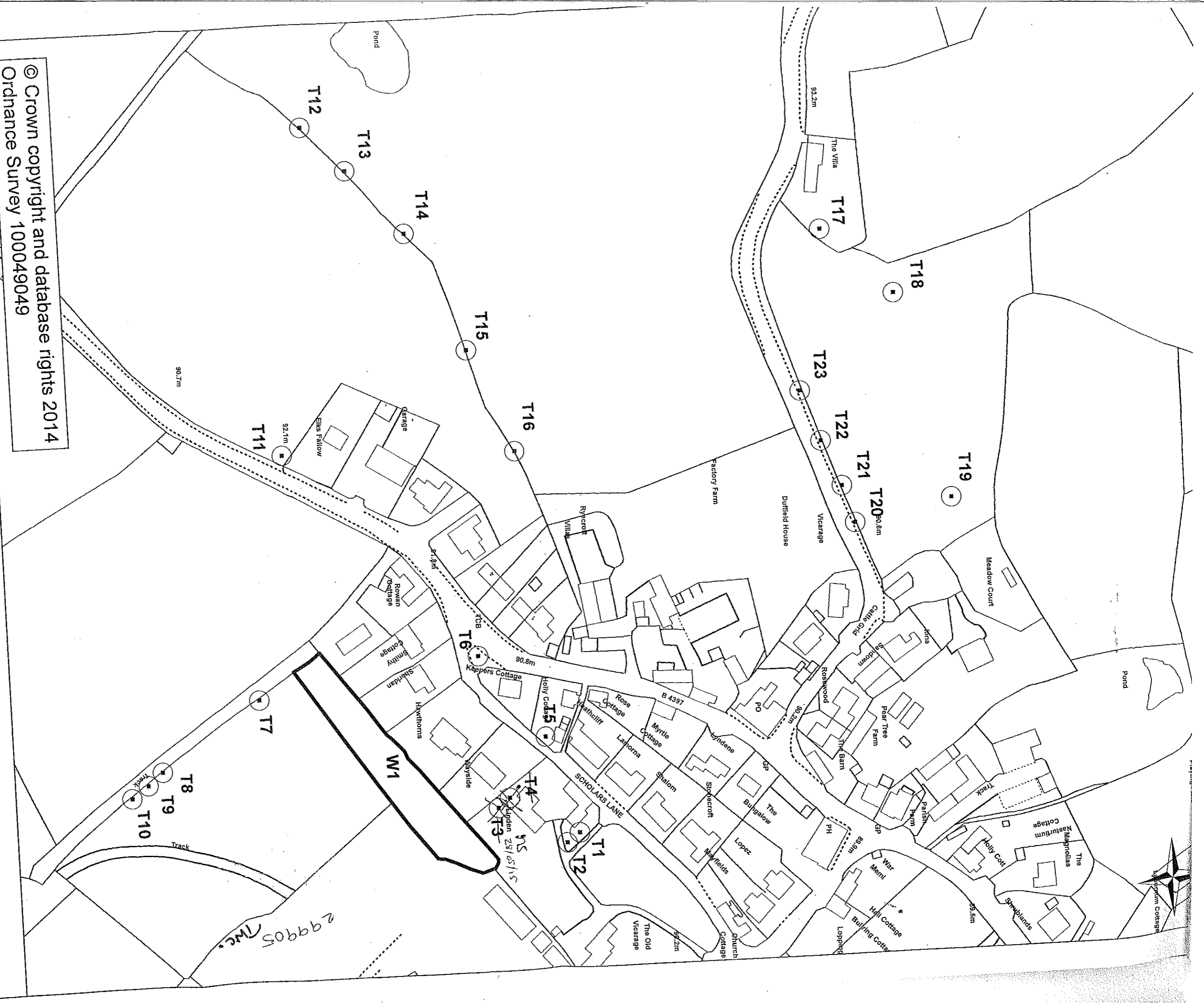

SCHEDULE 1

SPECIFICATION OF TREES

TREES SPECIFIED INDIVIDUALLY
(encircled in black on map)

Map ref	Description;	Situation
T1	Lime	North of Linden at grid ref Easting:34706, Northing:32923.

Map ref	Description;	Situation
T2	Pine	North of Linden at grid ref Easting:34706, Northing:32923.

Map ref	Description;	Situation
T3	Larch	South of Linden at grid ref Easting:34704, Northing:32919. NS 28/05/15

Map ref	Description;	Situation
T4	Silver Birch	Linden at grid ref Easting:34704, Northing:32920. NS 28/05/15

Map ref	Description;	Situation
T5	Common Ash	Holly Cottage at grid ref Easting:34701, Northing:32922.

Map ref	Description;	Situation
T6	Copper Beech	South of Keepers Cottage at grid ref Easting:34698, Northing:32919.

Map ref	Description;	Situation
T7	Oak	Along track south of Charleston Way at grid ref Easting:34699, Northing:32909.

Map ref	Description;	Situation
T8	Sycamore	Along track south of Charleston Way at grid ref Easting:34702, Northing:32905.

Map ref	Description;	Situation
T9	Oak	Along track south of Charleston Way at grid ref Easting:34703, Northing:32904.

Map ref	Description;	Situation
T10	Field Maple	Along track south of Charleston Way at grid ref Easting:34703, Northing:32903.

Map ref	Description;	Situation
T11	Oak	South of Elks Fallow at grid ref Easting:34688, Northing:32911.

Map ref	Description;	Situation
T12	Oak	Field boundary north of B4397 at grid ref Easting:34674, Northing:32912.

Map ref	Description;	Situation
T13	Oak	Field boundary north of B4397 at grid ref Easting:34676, Northing:32914.

Map ref	Description;	Situation
T14	Oak	Field boundary north of B4397 at grid ref Easting:34679, Northing:32917.

Map ref	Description;	Situation
T15	Oak	Field boundary north of B4397 at grid ref Easting:34684, Northing:32919.

Map ref	Description;	Situation
T16	Oak	Field boundary north of B4397 at grid ref Easting:34689, Northing:32921.

Map ref	Description;	Situation
T17	Walnut	The Villa at grid ref Easting:34680, Northing:32935.

Map ref	Description;	Situation
T18	Oak	NE of The Villa at grid ref Easting:34683, Northing:32938.

Map ref	Description;	Situation
T19	Oak	West of Meadow Court at grid ref Easting:34692, Northing:32940.

Map ref	Description;	Situation
T20	Horse Chestnut	Road boundary east of The Villa at grid ref Easting:34693, Northing:32936.

Map ref	Description;	Situation
T21	Horse Chestnut	Road boundary east of The Villa at grid ref Easting:34691, Northing:32935.

Map ref	Description;	Situation
T22	Horse Chestnut	Road boundary east of The Villa at grid ref Easting:34689, Northing:32935.

Map ref	Description;	Situation
T23	Horse Chestnut	Road boundary east of The Villa at grid ref Easting:34687, Northing:32934.

TREES SPECIFIED BY REFERENCE TO AN AREA
(none)

GROUPS OF TREES
(none)

WOODLANDS
(within a continuous black line on the map)

Map ref	Description;	Situation
W1	Mixed Larch / Scots Pine / Ash (not Poplar)	Land at Loppington at grid ref Easting:34702, Northing:32915.